

# Threaded Flat Face Couplings Connect Under Pressure



## Series: VP

### VP Series:

- High working pressures: 400-600 bar range based on size.
- Thread coupling system eliminates brinelling, premature leakage
- Connect / disconnect under residual pressure up to 300 bar
- Valve limits fluid movement during connection avoiding damage to other elements of circuit.
- Low connection force required
- Safety Auto-Lock feature upon connecting.

- Fire Tested and Lloyd's Certified in compliance with API 16D Test and EUB Directive 36.  
(Lloyd's document available upon request)

**Overview:** Stucchi VP Series is the ultimate solution most popular to hydraulic circuit applications subject to high pressure impulses, and circuits which experience high residual or trapped pressure in a line. The VP thread to connect design eliminates premature wear or brinelling associated with locking ball designs subjected to high impulse pressures. The *patented internal valve* allows *connection and disconnection* with high residual pressures. Flat-Face design avoids loss of hydraulic fluid during connection / disconnection. Flat-Face design is easy to clean, limiting contamination into the circuit.

### Applications & Features:

- Excavators w/ auxiliary line for attachments: Thumbs, Grapples, Hammers.
- Oil Field, Well Head Drives, Porta-Power.
- Cranes, Drilling machines, all large equipment needing junction points in circuit.
- All construction equipment applications with higher pressure requirements or issues of connecting / disconnecting tool attachments under residual pressure.
- Connect/Disconnect up to 300 bar residual pressure.
- Save time changing tools.

Stucchi Series	Nominal Size	ISO Size	MAX OPERATING PRESSURE COUPLED bar	MAX OPERATING PRESSURE COUPLED PSI
VEP	Inches	MM		
VP7	1/4	6.3	600	8571
VP9	3/8	10.0	550	7857
VP13	1/2	12.5	550	7857
VP15	3/4	16.0	550	7857
VP17	1	19.0	500	7142
VP21	1 ¼	25.0	470	6714
VP30	1 ½	31.5	400	5714



Item	Body Size	Size (MM)	A inch	B (mm)	C (mm)	D (mm)	E (mm)	F (mm)	G (mm)	I (mm)
VP 7	1/4"	6.3	1/4"	83.9	M24x2	52.8	125.2	24	29	35
VP 9	3/8"	10	3/8"	94.5	M28x2	64.3	142.3	29	32	42
VP 9	3/8"	10	1/2"	94.5	M28x2	69.3	147.3	29	32	42
VP 13	1/2"	12.5	1/2"	110	M36x3	76.2	167.9	38.5	40	49
VP 13	1/2"	12.5	3/4"	110	M36x3	83.2	174.9	38.5	40	49
VP 15	3/4"	16	3/4"	110	M39x3	83.4	174.9	38.5	44.8	52
VP 17	1	19	1	127.1	M45x3	96	200.5	49.8	49.8	60
VP 21	1 1/4"	25	1 1/4"	137	M55x3	105	214.8	59.8	59.8	76
VP 30	1 1/2"	31.5	1 1/2"	174.7	G 1-1/2	132.2	271.3	69.8	72	82

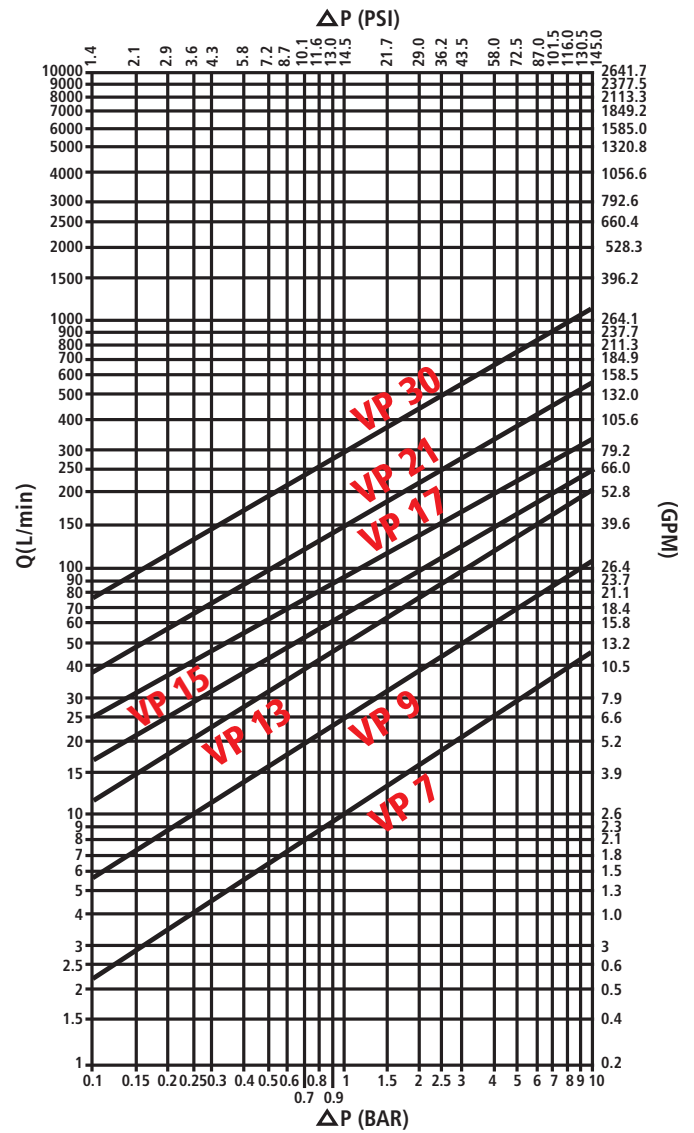
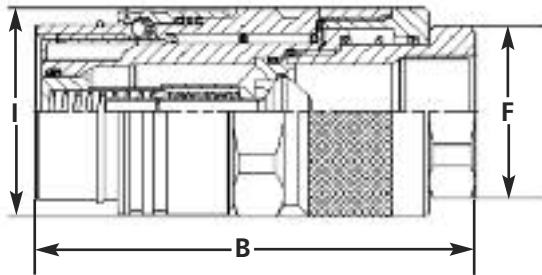
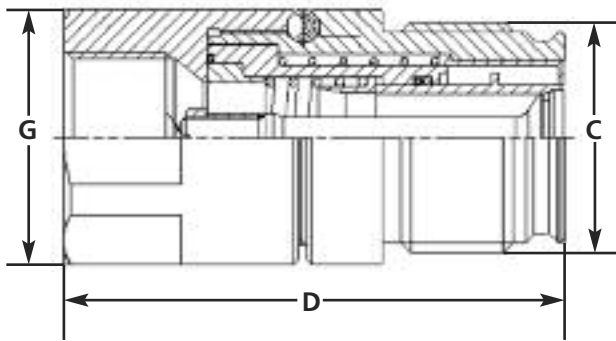
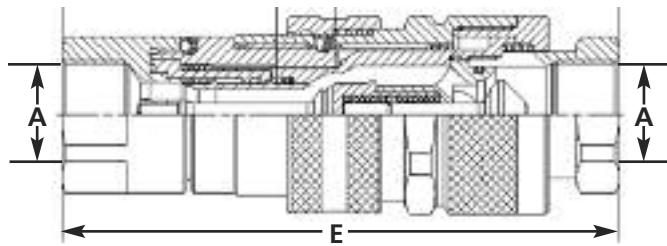

# Threaded Flat Face Couplings Connect Under Pressure



Coupler



Nipple



Coupler



Nipple

## Flat-Face Thread connect w/ High Residual Pressure –Auto Lock Series: VP-NPT Thread

Part	Body Size	Port Size	Thread Type	Order Code	Part Description
Coupler	1/4	1/4	NPT	801901004	F. VP7P 1/4 NPT
Nipple	1/4	1/4	NPT	801901005	M.VP7P 1/4 NPT
Coupler	3/8	3/8	NPT	801901010	F. VP9P 3/8 NPT
Nipple	3/8	3/8	NPT	801901011	M. VP9P 3/8 NPT
Coupler	3/8	1/2	NPT	801901000	F. VP9P 1/2 NPT
Nipple	3/8	1/2	NPT	801901001	M. VP9P 1/2 NPT
Coupler	1/2	1/2	NPT	801901006	F. VP13P 1/2 NPT
Nipple	1/2	1/2	NPT	801901007	M. VP13P 1/2 NPT
Coupler	1/2	3/4	NPT	801901008	F. VP13P 3/4 NPT
Nipple	1/2	3/4	NPT	801901009	M. VP13P 3/4 NPT
Coupler	3/4	3/4	NPT	801901002	F. VP15P 3/4 NPT
Nipple	3/4	3/4	NPT	801901003	M. VP15P 3/4 NPT
Coupler	1	1	NPT	801901012	F. VP17P 1" NPT
Nipple	1	1	NPT	801901013	M.VP17P 1" NPT
Coupler	1 1/4	1 1/4	NPT	801901014	F. VP21P 114 NPT
Nipple	1 1/4	1 1/4	NPT	801901015	M. VP21P 114 NPT
Coupler	1 1/2	1 1/2	NPT	801901016	F. VP30P 112 NPT
Nipple	1 1/2	1 1/2	NPT	801901017	M. VP30P 112 NPT

## Flat-Face Thread connect w/ High Residual Pressure –Auto Lock Series: VP-SAE Thread

Part	Body Size	Port Size	Thread Type	Order Code	Part Description
Coupler	3/8	3/8	SAE	807304020	F. VP9P 3/8 SAE
Nipple	3/8	3/8	SAE	807304021	M.VP9P 3/8 SAE
Coupler	1/2	1/2	SAE	807304022	F.VP13P 1/2 SAE
Nipple	1/2	1/2	SAE	807304023	M.VP13P 1/2 SAE
Coupler	1/2	3/4	SAE	807304008	F.VP13P 3/4 SAE
Nipple	1/2	3/4	SAE	807304009	M.VP13P 3/4 SAE
Coupler	3/4	3/4	SAE	807304010	F.VP15P 3/4 SAE
Nipple	3/4	3/4	SAE	807304011	M.VP15P 3/4 SAE
Coupler	1	1	SAE	807304012	F.VP17P 1" SAE
Nipple	1	1	SAE	807304013	M.VP17P 1" SAE
Coupler	1 1/4	1 1/4	SAE	807304014	F.VP21P 114 SAE
Nipple	1 1/4	1 1/4	SAE	807304015	M.VP21P 114 SAE
Coupler	1 1/2	1 1/2	SAE	807304016	F.VP30P 112 SAE
Nipple	1 1/2	1 1/2	SAE	807304017	M.VP30P 112 SAE

Caps & Plugs Available: Pg. 78  
BSP Ports available upon request

