

ISO 16028 Interchange Couplings 316 Stainless Steel



Overview:

FL Series have been designed for corrosive environments or the transmission of corrosive fluids. FM Series have been designed for hydraulic applications and offshore applications involving high salt or corrosive environments. FM Series suitable for use at depths of 1000m when connected.

Features & Options:

- No air inclusion during connection
- Flat Face can easily be cleaned limiting contamination into system
- Non-Spill design eliminates leaks
- Minimal pressure drop design
- Springs in AISI 302 stainless steel
- Balls in AISI 316
- Anti-extrusion rings are in pure Teflon
- Standard threads are BSP and NPT: other threads are available on demand
- Standard seals: VITON

Series: FL Series: FM FL Series – 316 SS

The “FL” variation of the “FIRG” series is the Stucchi Solution for high corrosion applications. The resistance to corrosion & excellent fatigue life make this product ideal for applications in chemicals, pharmaceutical, food and offshore. The interchangeability of “FL” series couplings is in accordance with **ISO 16028**.

Interchange: ISO 16028 FM Series – 316 SS w/QPQ

The “FM” is the solution for offshore marine hydraulic applications. Ideal for all under water applications, FM has added QPQ treatment for a higher working pressure. Interchange with **ISO 16028**.

Stucchi Series	Nominal Size Inches	ISO Size MM	MAX OPERATING PRESSURE COUPLED FL Series bar	MAX OPERATING PRESSURE COUPLED FM Series bar
FL4/FM4	1/8	5.0	330	Not Available
FL7/FM7	1/4	6.3	250	350
FL9/FM9	3/8	10.0	250	350
FL13/FM13	1/2	12.5	200	350
FL15/FM15	5/8	16.0	200	350
FL17/FM17	3/4	19.0	200	330
FL21/FM21	1	25.0	160	280
FL27/FM27	1 ½	31.5	125	230
FL45/FM45	2	40.0	100	Not Available

ISO 16028 Interchange Couplings 316 Stainless Steel

Item	Body Size	Size (MM)	A inch	B (mm)	C (mm)	D (mm)	E (mm)	F (mm)	G (mm)	I (mm)
FL7	1/4"	6.3	1/4"	47.9	28	48.1	85.2	23.8	23.8	16.2
FL9	3/8"	10	3/8"	60	32	64.2	108.7	26	29	19.8
FL9	3/8"	10	1/2"	62.5	32	69.2	116.2	29	29	19.8
FL13	1/2"	12.5	1/2"	68	38	73.8	124.6	33.8	33.8	24.5
FL13	1/2"	12.5	3/4"	70.5	38	80.8	134.1	38.5	38.5	24.5
FL15	5/8"	16	3/4"	70.5	42	78.5	131.5	38.5	38.5	27
FL17	3/4"	19	1"	82.5	48	93.2	153.9	47.8	47.8	30
FL21	1"	25	1 1/2"	90	55	106	173	59.8	59.8	36
FL27	1 1/2"	31.5	1 1/2"	111	80	132.4	215	72	76	57
FL45	2"	40	2"	125	100	156.6	242.8	83.5	88.5	73

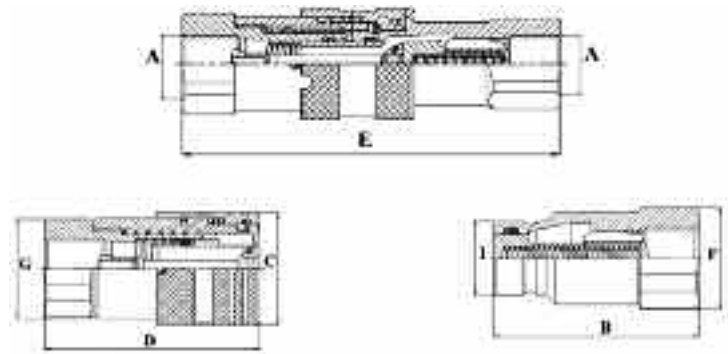
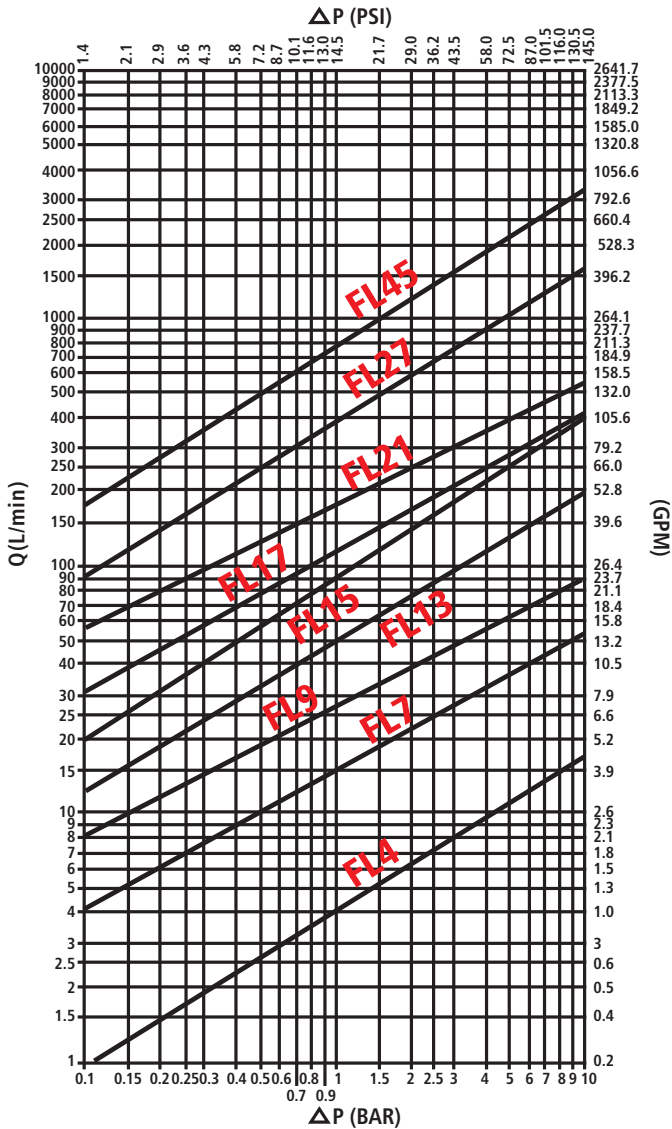

Male thread option available upon request.



ISO 16028 Interchange Series: FL – 316 Stainless

Part	Body Size	Port Size	Thread Type	Order Code	Part Description
Coupler	1/8	1/8	NPT	802401118	F. FL4 1/8 NPT
Nipple	1/8	1/8	NPT	802401119	M.FL4 1/8 NPT
Coupler	1/4	1/4	NPT	802401100	F. FL7 1/4 NPT
Nipple	1/4	1/4	NPT	802401101	M.FL7 1/4 NPT
Coupler	3/8	3/8	NPT	802401102	F. FL9 3/8 NPT
Nipple	3/8	3/8	NPT	802401103	M.FL9 3/8 NPT
Coupler	3/8	1/2	NPT	802401104	F. FL9 1/2 NPT
Nipple	3/8	1/2	NPT	802401105	M.FL9 1/2 NPT
Coupler	1/2	1/2	NPT	802401106	F. FL13 1/2 NPT
Nipple	1/2	1/2	NPT	802401107	M.FL13 1/2 NPT
Coupler	1/2	3/4	NPT	802401108	F. FL13 3/4 NPT
Nipple	1/2	3/4	NPT	802401109	M.FL13 3/4 NPT
Coupler	5/8	3/4	NPT	802401110	F. FL15 3/4 NPT
Nipple	5/8	3/4	NPT	802401111	M.FL15 3/4 NPT
Coupler	3/4	1	NPT	802401112	F. FL17 1" NPT
Nipple	3/4	1	NPT	802401113	M.FL17 1" NPT
Coupler	1	1 ¼	NPT	802401114	F. FL21 1¼ NPT
Nipple	1	1 ¼	NPT	802401115	M.FL21 1¼ NPT
Coupler	1 ½	1 ½	NPT	802401116	F. FL27 1½ NPT
Nipple	1 ½	1 ½	NPT	802401117	M.FL27 1½ NPT
Coupler	2	2	NPT	802401120	F. FL45 2" NPT
Nipple	2	2	NPT	802401121	M.FL45 2" NPT



Coupler



Nipple

ISO 16028 Interchange Series: FM – 316 Stainless: w/QPQ Plating

Part	Body Size	Port Size	Thread Type	Order Code	Part Description
Coupler	1/8	1/8	NPT	802301122	F. FM4 1/8 NPT
Nipple	1/8	1/8	NPT	802301123	M.FM4 1/8 NPT
Coupler	1/4	1/4	NPT	802301100	F. FM7 1/4 NPT
Nipple	1/4	1/4	NPT	802301101	M.FM7 1/4 NPT
Coupler	3/8	3/8	NPT	802301102	F. FM9 3/8 NPT
Nipple	3/8	3/8	NPT	802301103	M.FM9 3/8 NPT
Coupler	3/8	1/2	NPT	802301104	F. FM9 1/2 NPT
Nipple	3/8	1/2	NPT	802301105	M.FM9 1/2 NPT
Coupler	1/2	1/2	NPT	802301106	F. FM13 1/2 NPT
Nipple	1/2	1/2	NPT	802301107	M.FM13 1/2 NPT
Coupler	1/2	3/4	NPT	802301108	F. FM13 3/4 NPT
Nipple	1/2	3/4	NPT	802301109	M.FM13 3/4 NPT
Coupler	5/8	3/4	NPT	802301110	F. FM15 3/4 NPT
Nipple	5/8	3/4	NPT	802301111	M.FM15 3/4 NPT
Coupler	3/4	1	NPT	802301112	F. FM17 1" NPT
Nipple	3/4	1	NPT	802301113	M.FM17 1" NPT
Coupler	1	1 ¼	NPT	802301114	F. FM21 1¼ NPT
Nipple	1	1 ¼	NPT	802301115	M.FM21 1¼ NPT
Coupler	1 ½	1 ½	NPT	802301116	F. FM27 1½ NPT
Nipple	1 ½	1 ½	NPT	802301119	M.FM27 1½ NPT
Coupler	2	2	NPT	802301118	F. FM45 2" NPT
Nipple	2	2	NPT	802301121	M.FM45 2" NPT



Coupler



Nipple