

## ISO-A Interchange Coupling



**Overview:** ISO A style couplings are one of the most popular designs worldwide used in agricultural, mobile equipment, and some industrial applications. The ISO A style is a durable product using a poppet style valve for the sealing mechanism. The Stucchi breadth of product exceeds that of most competitors by offering sizes over 1".

### Technical Characteristics

- Coupling Body: zinc plated steel
- Nipple is zinc plated hardened steel
- Seals: Nitrile
- Anti extrusion rings are Teflon
- NPT standard threads
- On request BSP threads & various seals
- Anti dust plastic caps
- Clip provided "Auto Shut" Nylon caps for BIR12 female coupler part available

### Series: BIR

#### Interchange: ISO A

"BIR" quick couplings are interchangeable according to the ISO 7241-1 series "A". They are available from size 1/4 to size 2", to cover the various fields of hydraulic applications. The series "BIR" couplings are the most used, from industrial plants to agriculture.

#### Interchange: Parker 6600, Aeroquip 5600, Faster ANV

- Positive-stop valving prevents flow checking
- Large diameter sleeves resist deformation
- Steel sleeves hardened for maximum life
- Suitable for "Open Center" or "Closed Center" hydraulic system

Body Size	ISO Size	MAX Operating Pressure Coupled bar	MAX Operating Pressure Coupled PSI
Inch	MM		
1/4	6.3	350	5000
3/8	10	300	4285
1/2	12.5	250	3571
3/4	20	250	3571
1	25	230	3285
1 ¼	31.5	230	3285
1 ½	40	180	2571
2	50	130	1857



Item	Body Size	Size (MM)	A inch	B (mm)	C (mm)	D (mm)	E (mm)	F (mm)	G (mm)
BIR 14	1/4"	6.3	1/4	32	26	47	64.5	21	22
BIR 38	3/8"	10	3/8	38	31	56	76.5	24	24
BIR 12	1/2"	12.5	1/2	44.5	38	63.3	86	29	30
BIR 34	3/4"	20	3/4	55	48	82	111	38.5	44
BIR 100	1"	25	1	63	54	97	127	45	52
BIR 114	1 1/4"	31.5	1 1/4	75	65	117	151	60	56
BIR 112	1 1/2"	40	1 1/2	85	80	135	171	65.5	65.5
BIR 200	2"	50	2	100	100	160	201	82.5	83.5

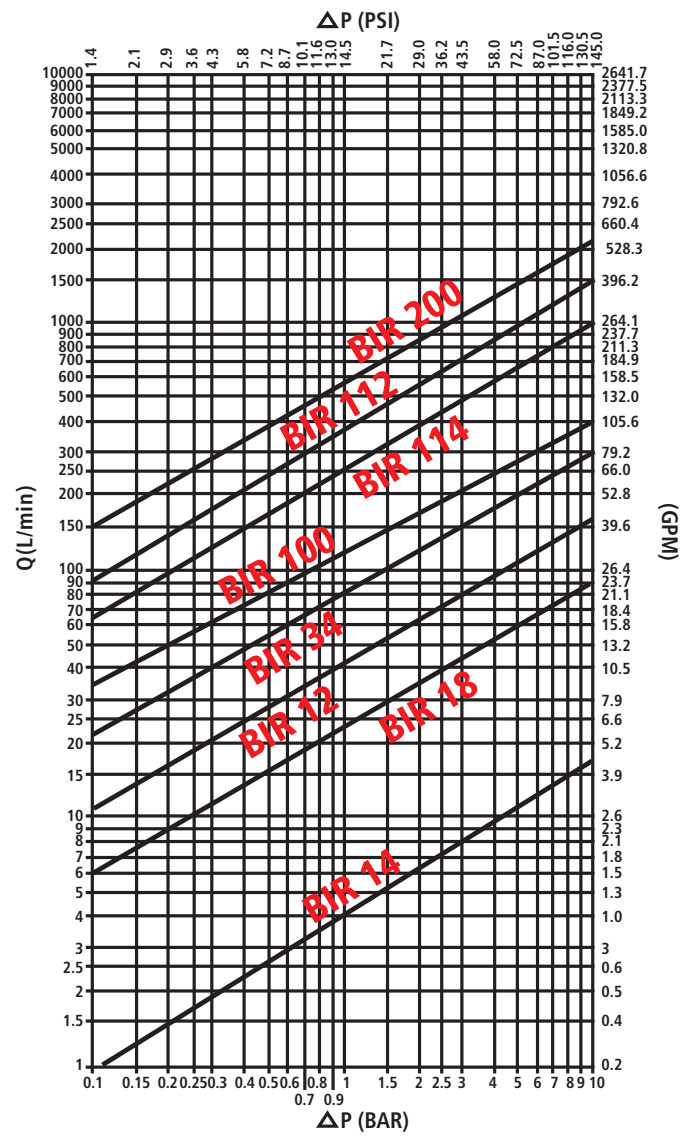
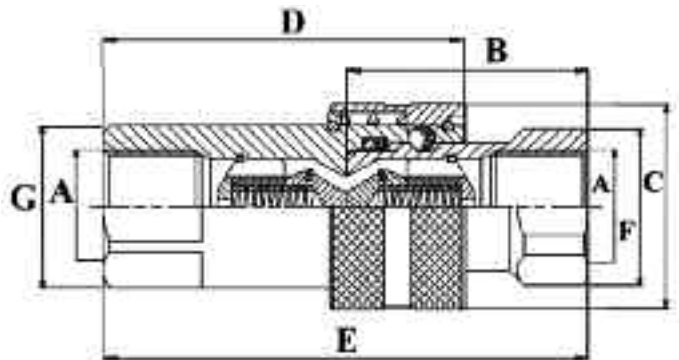

# ISO-A Interchange Coupling

## NPT Thread



Coupler



Nipple

### Interchange: Parker 6600, Aeroquip 5600, Faster ANV ISO A Interchange: -BIR Series

Part	Body Size	Port Size	Thread Type	Order Code	Part Description
Coupler	1/4	1/4	NPT	800501000	F. BIR 14 NPT
Nipple	1/4	1/4	NPT	800501001	M. BIR 14 NPT
Coupler	3/8	3/8	NPT	800501002	F. BIR 38 NPT
Nipple	3/8	3/8	NPT	800501003	M. BIR 38 NPT
Coupler	1/2	1/2	NPT	800501004	F. BIR 12 NPT
Nipple	1/2	1/2	NPT	800501005	M. BIR 12 NPT
Coupler	3/4	3/4	NPT	800501006	F. BIR 34 NPT
Nipple	3/4	3/4	NPT	800501007	M. BIR 34 NPT
Coupler	1	1	NPT	800501008	F. BIR 100 NPT
Nipple	1	1	NPT	800501009	M. BIR 100 NPT
Coupler	1 ¼	1 ¼	NPT	800501010	F. BIR 114 NPT
Nipple	1 ¼	1 ¼	NPT	800501011	M. BIR 114 NPT
Coupler	1 ½	1 ½	NPT	800501012	F. BIR 112 NPT
Nipple	1 ½	1 ½	NPT	800501013	M. BIR 112 NPT
Coupler	2	2	NPT	800501014	F. BIR 200 NPT
Nipple	2	2	NPT	800501015	M. BIR 200 NPT

### Interchange: Parker 6600, Aeroquip 5600, Faster ANV ISO A Interchange: -BIR Series

Part	Body Size	Port Size	Thread Type	Order Code	Part Description
Coupler	1/2	1/2	NPT	805601000	F. BIR 12 PC NPT*
Nipple	1/2	1/2	NPT	805601001	M. BIR 12 PC NPT*



\*Connect under residual pressure poppet valve



Call us at 847-956-9720, Fax at 847-956-9723, or visit us on the web [www.stucchiusa.com](http://www.stucchiusa.com)